

ADNA SERIES

ANA M-RGB/RGBW



YYZ Adna series is a type of miniature fixture made in aluminum which is ideal for façade and landscape applications, where size of the fixture installed plays a critical role. These luminaires are designed to offer functional, a wide range of lighting solutions and dramatic highlighting of the architectural facades, landscapes, trees through the superior finishing as well highest efficiency with a long service life. This product provide uniform, soft enhancing special lighting effect that blends into the space being lit, to maximizes light beauty.

FEATURES

MATERIAL	Die-cast aluminum
FINISH	White, Black, Silver Grey , Graphite
RATED POWER	4x2W, 4x3W
WORKING VOLTAGE	100-240 V AC, 24V DC
BEAM ANGLE	15°, 24°, 45°
MOUNTING	Ground / Spike
CONNECTION	Outdoor rated connections
LAMP LIFE	50,000 hrs
DIMENSIONS	100x100x100 mm
OPERATION TEMP	-20° C - +50° C



- CREE, LUMILEDS, BRIDGELUX
LED Quality
- 24VDC
Working Voltage
- 4x2W/4x3W
Rated power

ELECTRICAL DATA

POWER CONSUMPTION	4x2W, 4x3W
SUPPLY VOLTAGE	220-240V ac
COLORS	RGB, RGBW
CRI	80+

DRAWING

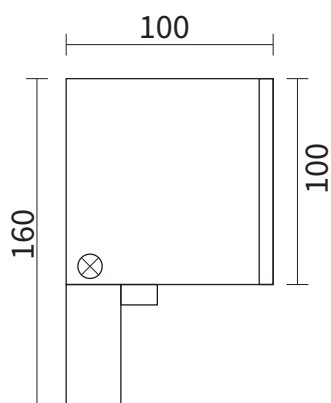

ORDERING LOGIC

PRODUCT	WATTAGE	OPTIC	COLOR TEMPERATURE	VOLTAGE	MOUNTING	FINISH	ACCESSORIES	CUSTOM
ANA M	8 - 4x2W	15	15°	RGB	RGB	AC - 100-240V AC	SP - Spike	XX - XXX
	12 - 4x3W	24	24°	RGBW	RGBW	DC - 24V DC	SM - Surface Mount	
		45	45°					

Sample: ANA M - 8 - 15 - RGB - AC - SP - WH - SP - XX